



Fountaine Pajot SABA 50

€820,000 • TARRAGONA France • Used • 2016

Presented by

Olivier Haroche
Phone: +34 637 510 716

Barcelona Yachting
Port Olimpic - Local 14
08005 Barcelona
Spain



Details

| | |
|--------------|--------------------------|
| Make: | Fountaine Pajot |
| Model: | SABA 50 |
| Year: | 2016 |
| Condition: | Used |
| Engine: | Volvo Penta D2 75, 75 hp |
| Engine type: | |
| Fuel type: | Diesel |
| Length: | 14.97 m (49.11 ft) |
| Beam: | 7.98 m (26.18 ft) |
| Cabins: | 0 |
| Berths: | 0 |

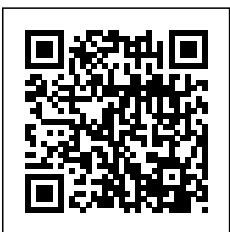

Barcelona
Yachting

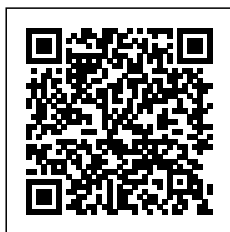

7zea.com

Description

FR
Fontaine Pajot SABA 50 de 2016, pavillon Français, prix TTC

5 cabines (1 propriétaire, 3 guests et 1 skipper).

Conçu pour offrir un bon équilibre entre confort et vitesse de croisière, même avec une mer agitée.

Parc batterie neuf décembre 2024

Grand-voile lattée à corne, révisée en 2023,

Génois également, et un Spi asymétrique quasi neuf.

Visible tous les jours à Tarragona. Amarre 900euros/mois

Pour plus d'informations ou pour organiser une visite, veuillez me contacter.

EN

Fontaine Pajot SABA 50 from 2016, French flag, price including VAT

5 cabins (1 owner, 3 guests, and 1 skipper).

Fully battened mainsail with square top, serviced in 2023,

Genoa also serviced, and an almost new asymmetric spinnaker.

Available for viewing every day in Tarragona. mooring, 900/month

For more information or to arrange a visit, please contact me.

ES

Fontaine Pajot SABA 50 de 2016, pabellón francés, precio con IVA incluido

5 cabinas (1 propietario, 3 invitados y 1 tripulación).

Gran vela mayor con sables en el grátil, revisada en 2023,

Génova también, y un spi asimétrico casi nuevo.

Visible todos los días en Tarragona. Amarre 900€/mes

Para más información o para organizar una visita, por favor contácteme.

General information

| | |
|------------|----------------|
| Make: | Fontaine Pajot |
| Model: | SABA 50 |
| Year: | 2016 |
| Condition: | Used |

Engine

| | |
|--------------|--------------------------|
| Engine: | Volvo Penta D2 75, 75 hp |
| Engine type: | |
| Fuel type: | Diesel |

Measurements

| | |
|---------|--------------------|
| Length: | 14.97 m (49.11 ft) |
| Beam: | 7.98 m (26.18 ft) |
| Deep: | 1.3 m (4.27 ft) |
| Weight: | 0 kg (0.00 lb) |

Accommodation

| | |
|---------|---|
| Cabins: | 0 |
| Berths: | 0 |

Images









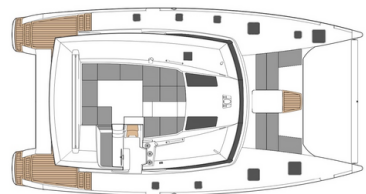
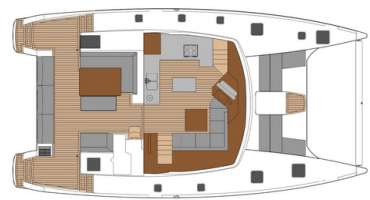
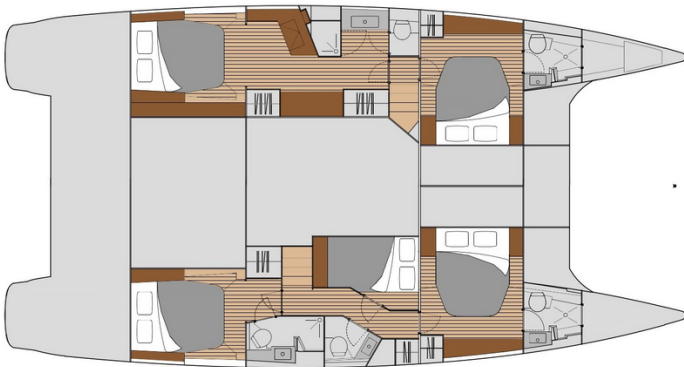

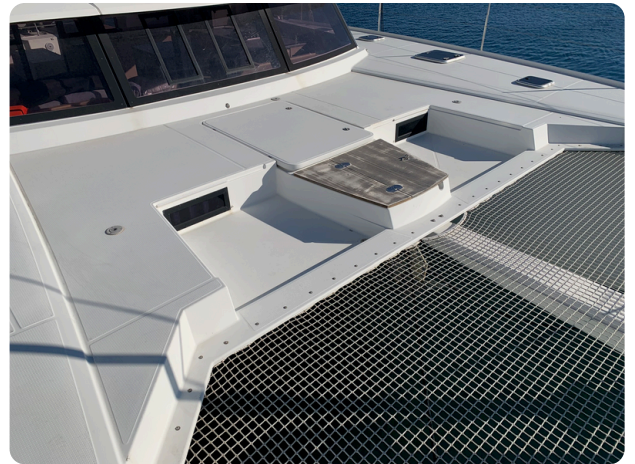





Barcelona Yachting

Port Olímpic - Local 14

08005 Barcelona

Spain

Phone: +34 637 510 716

<https://www.barcelonayachting.com/>

